

## BRANCHING OUT PARKER

### Proposed Tree(s) and Location Drawing

Provide a list of proposed tree(s) and sketch of property with proposed tree placement. If you plan on planting a replacement tree within the Town's tree lawn area (*i.e.*, the area directly adjacent to your lot between the curb-line and the sidewalk), please indicate this on your drawing. Trees purchased before receipt of program approval are not eligible for reimbursement. A preferred tree species list and drawing example is available online at [www.ParkerRec.com/BranchingOut](http://www.ParkerRec.com/BranchingOut). Species substitutions are permissible at a later date with the exception of those on the "prohibited" list. Contact Erik Stads vold at [estadsvold@parkeronline.org](mailto:estadsvold@parkeronline.org) with questions.

Species of Tree(s)	Number of Trees
American Elm	1
Colorado Blue Spruce	1

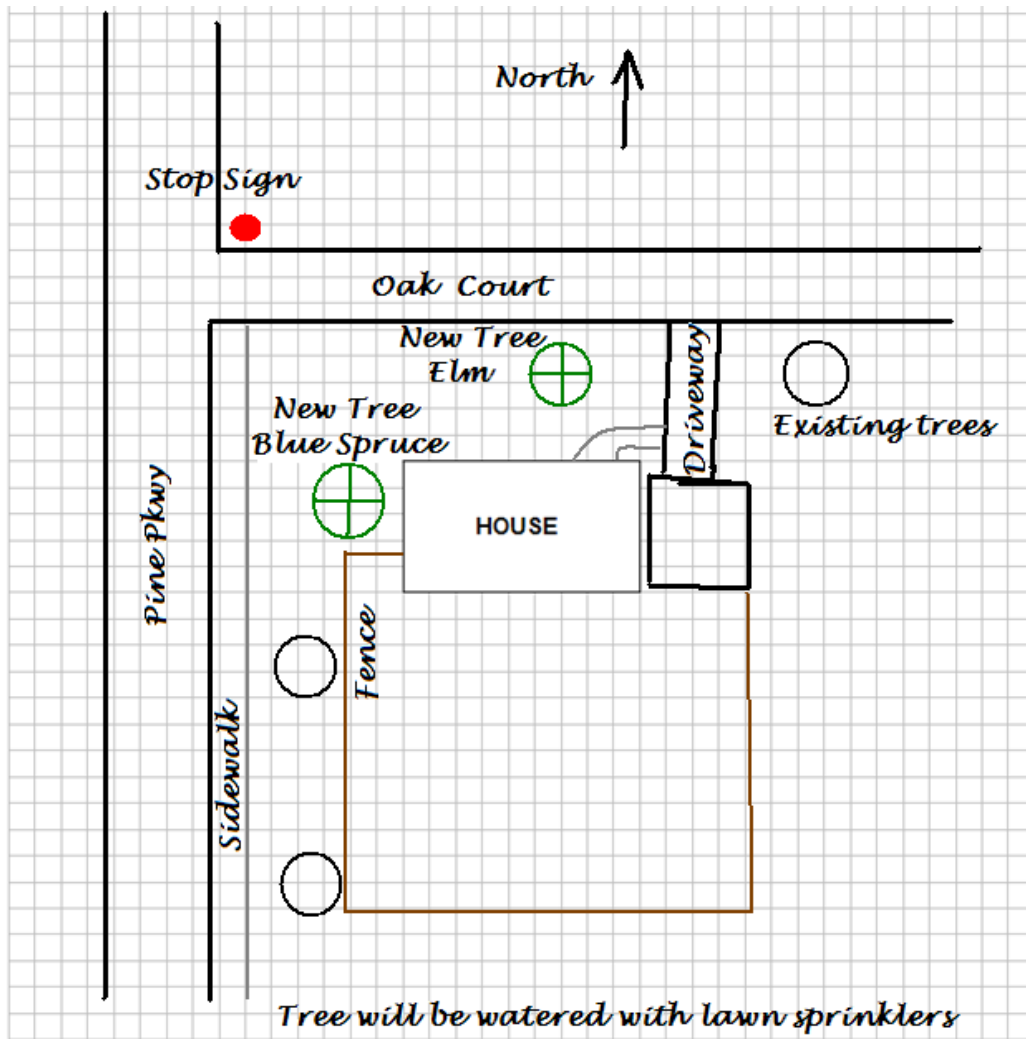

**Features to include:** *does not need to be to-scale*

- North arrow
- Street location(s) and name(s)
- Existing street sign locations
- Overhead power lines
- Underground utilities (*Please call the Utility Notification Center of Colorado at 1.800.922.1987 to schedule utility locates.*)
- Driveway, sidewalks, fences, porches and patios
- Existing trees and large shrubs
- Significant slopes and/or drainage swales
- Proposed tree planting location(s)
- Location and method of providing permanent irrigation for new tree(s)